



NEOP15' RIB TUBE PAINT

Application Guidelines

NEOP15' RIB Tube Paint is a durable two-component paint for PVC and Neoprene RIB Tubes, available in 10 standard colours and 2 500 on demand.

ADVANTAGES:

- Easy to use
- Typical coverage 8m² per litre
- Delivers high level of resistance against UV, weather and chemical agents
- Thermal resistance up to 180°C (356°F)
- Very high flexibility
- Apply with aerosol, spray gun or roller

IMPORTANT: Read full instructions before use.

This product contains hazardous materials and therefore appropriate protective equipment should always be used. Please refer to the label and consult the Safety Data Sheet for full handling instructions and personal protective information. Neop15 (UK) Limited and Neop15' disclaim any liability where the user does not wear the recommended personal protective equipment. The data is for information only and may change without prior notice. It is the Buyers responsibility to ensure the suitability of the products for their own use and to check that they are up to date. Please refer to the label and consult the Safety Data Sheet, Technical Data Sheet and Application Guidelines for full handling instructions and personal protection information. These are available via the website www.neop15.co.uk. Neop15 (UK) Limited and Neop15' are not responsible for the results obtained by others over whose methods we have no control and thereof Neop15 (UK) Limited and Neop15' are not liable for consequential or incidental damages including loss of profit.

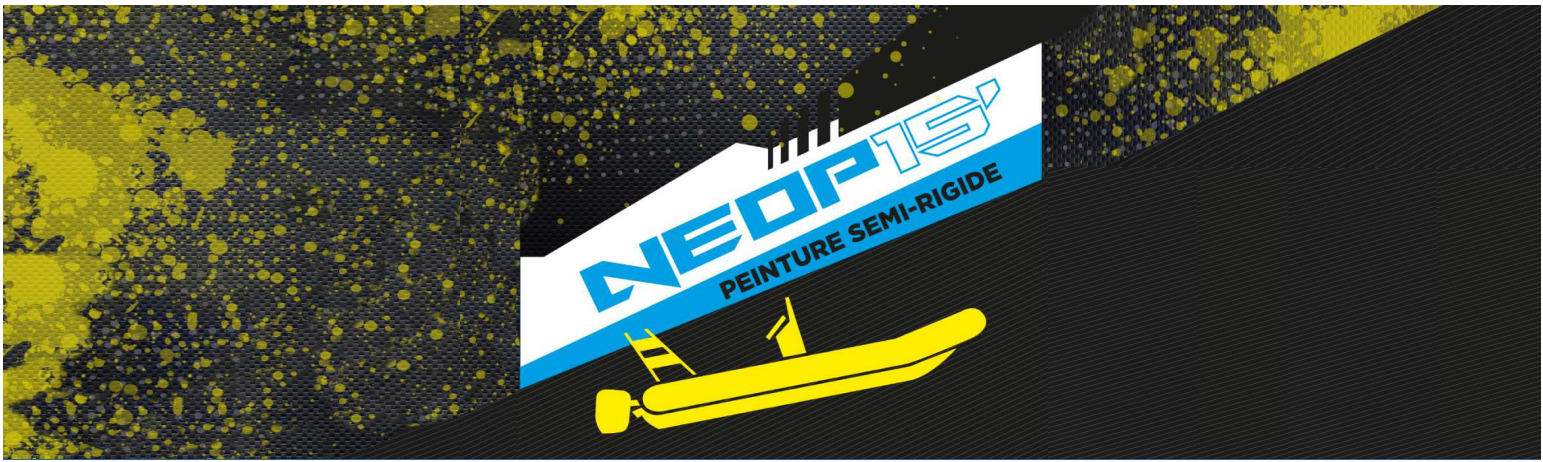

MIXING & ACTIVATION:

400ml Paint Aerosol & 250ml Varnish Aerosol

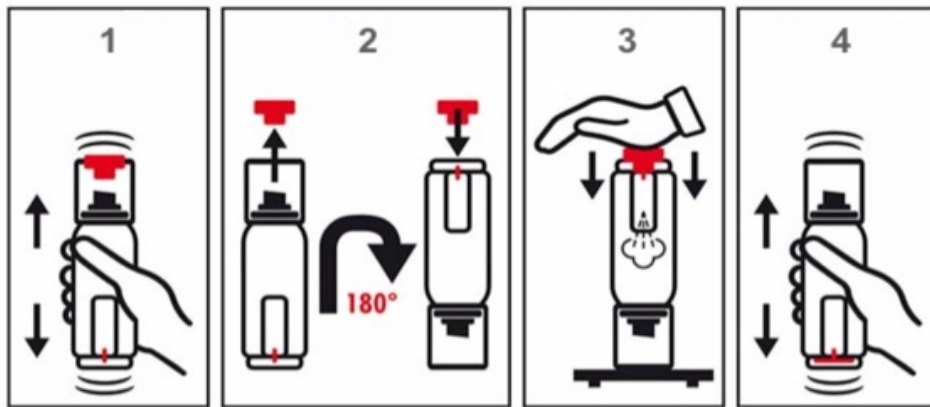

1. Shake can for two minutes before activation.
2. Remove the red button from the aerosol cap. Turn the can upside down and fit the button onto the pin in the base of the can.
3. With the cap still on, place the can on a firm surface. Push the button all the way down with the palm of your hand for at least 30 seconds to release the hardener into the aerosol.
4. Shake the can for two minutes before use.

Once activated the pot life is approximately 6 hours. Discard remaining product after 6 hours.

1 Litre Paint Kit

- Pour the entire contents (Paint, Hardener and Thinner) into the main pot and mix well.
- The mixed paint will be usable for the next 6 hours only.
- The paint can be applied using a standard spray gun.



PREPARATION:

It is important to carefully follow the instructions in order to obtain the best result.

- Completely clean the boat and RIB Tube using an appropriate RIB Tube cleaning shampoo.
- Degrease the Tube thoroughly using the appropriate degreaser before paint.
- Lightly sand the part of the RIB Tube to be painted using a sandpaper grade P240 for Neoprene tubes and P400 for PVC tubes.
- Where Neoprene has degraded, be careful not to damage the underlying mesh if visible. **If unclear as to the level of damage to the Tube please consult a professional prior to painting.**
- Thoroughly remove all dust from the Tube using a vacuum cleaner and damp cloth.
- Degrease the Tube thoroughly using the appropriate degreasing product for a second time.
- Protect/mask all areas not to be painted with masking tape and appropriate protective coverings.

PAINT & VARNISH APPLICATION:

- It is recommended to spray a test panel with the paint first to ensure the desired finish.
- Apply the first coat evenly using an even motion approximately 150-200mm from the surface of the Tube.
- Wait 24-48 hours to dry.
- Any blemishes or unevenness can be sanded gently once dry using a sandpaper grade P240 to get a smooth finish (this process can be repeated to ensure the finish).
- Apply 2nd & 3rd coats in the same manner as above leaving sufficient dry time between each.
- For Neoprene Tubes that are worn or where the underlying mesh is visible, we recommend up to 6 coats of paint to get a smooth finish. A light sanding is recommended between paint coats as well as the required dry time.
- Apply topcoat matt varnish in the same manner as paint.
- Leave to fully cure and harden for 10 days before altering the pressure in the Tube and before putting it in water, otherwise it will affect the finish.

VARNISH – ALTERNATIVE APPLICATIONS:

Varnish can be used on plastic handles and other fittings to rejuvenate the look.

- Thoroughly clean using a magic sponge all surfaces and leave to dry.
- Apply 1 coat of matt varnish and leave to fully dry for 1 hour.
- Apply 2nd coat of matt varnish.
- Leave to fully cure and harden for 10 days (if not, there is a risk of damage to the finish).



DRY TIME:

- Touch Dry at 20°C (68°F): 1 hour
- Time Between Coats: 24-48 hours
- Fully Cured at 20°C (68°F): 10 days

Thicker paint coats as well as higher or colder temperatures will affect the final cure time. Do not expose to water or heavy loads before the paint and varnish have fully cured, as this will affect the final finish.

SHELF LIFE:

- 12 months in sealed original packaging.
- Keep in a room ventilated at a temperature between 5°C (41°F) and 35°C (95°F).

NOTE:

Paint can be applied inside or outside, subject to the following conditions;

- Do not use in extreme cold or hot temperatures. Ideal application temperature is 20°C (68°F).
- Interior environments should be well ventilated and free of dust.
- External environments should be free of wind.
- We advise watering environments before use to avoid the possibility of creating dust.

Date: 14/10/2022